



## Moorings 4300 | 3-cabin

3 Cabins / 3 Heads

### Specifications and Equipment List (Moorings charter upgrades in bold)

Yacht Model:	Leopard 43
Length Overall:	42ft 7in   12.98m
Length waterline:	41ft   12.48m
Beam:	23ft   7.00m
Draft:	5ft 2in   1.57m
Fuel Capacity:	158 US Gal   600 L
Water Capacity:	174 US Gal   660 L
Engines:	2 x Yanmar 45 HP

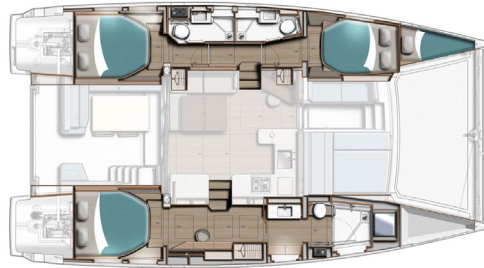

### DECK & HULL

- Guardwires with stanchions, bases
- Guardwires across bow and stern
- 1600w vertical windlass 10mm gypsy and capstan c/w hand-held remote
- Anchor bow roller fitting
- Anchor chain stopper
- Liferaft locker with convertible fore/aft seat bolster
- Sliding companionway door
- Hardtop over fwd and aft cockpit complete with LED down lighting
- Hardtop bimini over helm c/w s/s supports
- Folding swimming ladder c/w teak steps
- Aft Cockpit table
- 2 x Deck chairs (Director type)
- Bridle mainsheet system (3:1 purchase)
- Trampoline
- Helmseat with upholstered base and backrest
- Mineral Glass grey tinted windows
- Hardtop supports
- Hatches (3-cabin version):
  - Size 10 Flush Hatch: 2 x over port heads, 1 x owners heads and 1 x over study
  - Size 44 Flush Hatch: 3 x over cabins, 1 x over owner's heads and 2 x over forepeaks
- Portlights (3-cabin version):
  - Size 5 Portlights: 2x in windscreen
  - Size 1 Portlight: 7x in hull side and 2x transom
- 1 x Anchor/windlass locker with chain bin
- 2 x Foredeck/forward cockpit lockers
- Forward access to foredeck c/w watertight saloon access door
- 2 x Pulpits with seat
- 2 x Pushpits
- 4 x Coachroof handrails
- 2 x Coachroof grab handles
- 1 x Coachroof steps handrail
- 1 x Hardtop grab handle
- 2 x Transom grab handles
- 9 x 310mm mooring cleats (one inside Anchor locker)
- 2 x Winch handles
- **2 x Electric primary winches in lieu of standard primary winches**
- 1 x Main sheet winch
- 2 x Genoa Tracks & Cars with pin stop
- 2 x Halyard clutch at helm (main & spinnaker)

INITIALS \_\_\_\_\_

INITIALS \_\_\_\_\_

REV: 03-13-2026

Exhibit A

- 2 x Genoa sheet clutch at helm
- 2 x Mainsheet clutch at helm
- 2 x Reef clutch at helm
- 1 x Furler clutch at helm
- 1 x Genoa Halyard Clutch and cleat on mast
- Drinks holders - 2 x Doubles in forward cockpit and 1 x Double at helm
- **Aft Cockpit Cushions (Seats & backrests)**
- **Forward cockpit upholstery**
- **Removable helm station spray dodger**
- **Transom bumpers**
- **Custom stainless steel davit system with tackle and electric winch**
- **Stainless steel anchor and galvanized chain**
- **Additional anchor c/w 26ft (8m) chain & 200ft (61m) warp**
- **Anchor bridle, shackles and hook**

#### MAST, RIGGING & SAILS

- **Custom heavy duty battened charter mainsail**
- **Upgraded heavy duty furling genoa with UV protection**
- **Stackpack system in Moorings blue with logo**
- Natural anodized mast
- Natural anodized crossbeam c/w mooring cleats (x2)
- Wind indicator
- Genoa furler
- 2 x Additional spare 12v wires in mast
- Additional spare conduit with messenger in mast

#### NAVIGATION EQUIPMENT

- Compass at helm position

#### COACHROOF LOUNGE

- L-shaped settee
- **Coachroof lounge cushions (seats and backrests) and coachroof lounge table**

#### SALOON / INTERIOR

- Laminate finish on interior carpentry
- Wear resistant laminate flooring
- Saloon table - convertible to coffee table
- LED overhead lighting
- Ventilation through 2x forward facing size 5 portlights
- Forward doorway access to forward cockpit and foredeck
- Access to aft cockpit through sliding door
- 1 x Loose Bench stool to be used as Settee seating
- Joinery staircases to hull accommodation (Escape hatch located underneath staircases)
- 2 x Emergency escape panels (1 x in each corridor)
- 3 x Emergency escape panel glass breaking hammers
- **Upholstery Pack - Silvertex "Macadamia"**

#### GALLEY

- Solid surface worktop
- Single lever mixer faucet with pull-out sprayer
- 1 x Purified water tap
- Single bowl s/s sink
- Dish and cutlery drying recess with drainage
- Cover for drying recess
- Vitrifrigo 2-drawer fridge / freezer 56USgal / 212Ltr 12v
- 3-burner gas hob
- **Convection oven in lieu the gas oven**
- Gas solenoid shut-off valve with control at switch panel & warning light at cooker
- Gas detectors at gas connections to gas appliances
- Gas cylinder regulator in dedicated forward cockpit LPG locker
- Separate garbage bin locker

INITIALS\_\_\_\_\_

INITIALS\_\_\_\_\_

REV: 03-13-2026

Exhibit A

- Stowage space in shelf lockers
- Stowage space under floorboards
- 1 x Pot storage drawer below oven
- Drawer & spicerack alongside oven
- Outboard galley shelf with pull out drawers
- Smoke detector / alarm
- Carbon monoxide detector / alarm

#### NAVIGATION CONSOLE

- Chart table with storage locker under hinged lid
- LED overhead lighting
- 1 x Loose Ottoman stool to be used as Chart table seat

#### OWNER CABIN

- Laminate finish on interior carpentry
- Wear resistant laminate flooring
- Double berth (1.55m x 2.01m or 5'1" x 6'7")
- 1 x Hanging locker
- 1 x Double coat hook
- Vanity table/desk with storage locker with mirror under lid
- 1 x Loose Ottoman stool to be used in Owners Cabin (for 3 cabin layout only)
- Drawer unit with 3 x drawers
- 1 x Stowage drawer under bunk
- Sliding entrance door with lock
- LED downlight in study
- Concealed overhead rope lighting
- Concealed under bunk rope lighting
- 2 x LED reading lamps over bunk
- Smoke detector / alarm
- Carbon monoxide detector / alarm

#### HEADS (OWNER CABIN)

- Large washbasin with basin mixer
- Under-basin locker
- Separate shower compartment with divider c/w lever mixer and adjustable drainage system
- Shower sump with automatic drainage system
- Electric toilet with dual flush (Salt and Fresh)
- Double towel rail
- Double Coat hook
- Vanity Locker with mirror
- Dedicated trashcan toilet holder locker
- Large linen locker (can house optional washing machine)
- Sliding heads door
- Overhead roller blind for privacy
- Roller blind at window transition
- LED Overhead lighting

#### GUEST CABINS x 2

- Laminate finish on interior carpentry
- Wear resistant laminate flooring
- Double berths:
  - Forward Bunks (1.3m x 2.03m or 4'3" x 6'8")
  - Aft Bunk on port side (1.55m x 2.01m or 5'1" x 6'7")
- Hanging locker
- 1 x Double coat hook
- LED downlight in corridor
- 2 x LED reading lamps in each cabin
- Concealed overhead rope lighting
- Concealed under bunk rope lighting
- Overhead roller blinds for privacy
- Large open shelves

INITIALS\_\_\_\_\_

INITIALS\_\_\_\_\_

REV: 03-13-2026

Exhibit A

- Stowage under each bunk
  - Fwd cabins - 2 drawers
  - Aft cabins - 1 drawer
- Large hull window incorporating portlight and pleated blind
- Transom portlight in aft cabins
- Smoke detector / alarm
- Carbon monoxide detector / alarm

#### HEADS COMPARTMENTS x 2

- Washbasins with basin mixer
- Under-basin locker with toilet roll holder
- Vanity locker & mirror
- Double towel rail
- Sliding heads door
- Double Coat hook
- Shower compartment c/w lever mixer and adjustable shower rose
- Shower sump with automatic drainage system
- LED Overhead lighting
- Overhead roller blinds for privacy
- Roller blind at window transition
- Electric toilet with dual flush (Salt and Fresh)

#### FOREPEAKS

- **Forepeak child berth in port forepeak - Includes mattress and forepeak hatch shade. Direct access from the forward cabin.**
- Stowage space with access from forward cabin & deck on port side and from deck only on starboard side

#### ELECTRICAL INSTALLATION

- **Shore power pack**
- **Digital monitoring with AXIOM12 Multifunction display in lieu of AXIOM7 Multifunction display**
- LED Courtesy lights at stairways
- LED Bi-colour navlights, stern & anchor light
- 12v DC switch panel
- 1 x Double USB socket at helm station
- 1 x Double USB socket in each cabin
- House batteries - AGM type
- **Increased battery capacity**
- 2 x Engine starter batteries - AGM type
- 1 x House battery isolator switch
- 2 x Engine starter battery isolator switches
- 2 x Alternators, standard with engines
- 1 x Electrical spares kit: fuses, relays, fuse holders
- **Stereo system with speakers in saloon and aft cockpit**
- **Full Raymarine electronic package**
- **Generator**
- **Airconditioning**
- **Watermaker**
- **TV**
- **Solar panel**
- **Underwater lights**
- **Fans in the cabins**
- **Gas Plancha Grill installed in aft cockpit**
- **Refrigerator installed in aft cockpit**
- **Inverter Bypass Switch**

#### ENGINE & CONTROLS

- Double lever throttle / gearshift control
- Sound deadening panels in engine room
- 2 x Engine room ventilation fans and ducting
- 2 x Yanmar 45hp diesel engines with sail drives
- 2 x Propellers - fixed blade
- 2 x Fuel deck fillers

INITIALS\_\_\_\_\_

INITIALS\_\_\_\_\_

REV: 03-13-2026

## Exhibit A

- 2 x Fuel filter / water separators
- 2 x Fuel tanks 160USgal / 600Ltr total capacity
- 2 x Exhaust skin fittings (s/s)
- 2 x Exhaust water locks
- 2 x Cooling water inlet strainers
- 2 x Exhaust cooling water temperature sensors with audible alarms at helm

### RUDDER & STEERING SYSTEM

- Balanced spade rudders
- Rudder stock in 17-4 PH stainless steel with self aligning bearings
- Chain-and-cable steering system c/w bulkhead steering unit and brake
- Destroyer-type steering wheel
- Emergency tiller (s/s)

### RUNNING RIGGING

- 2 x Main sheets (3:1 purchase)
- 2 x Genoa sheets
- 3 x Halyards (main, genoa & spare)
- 2 x Single line reefs lead aft
- Main boom topping lift

### PLUMBING INSTALLATION

- Hot and cold pressurized fresh water system consisting of:
  - 2 x Water tanks, 174USgal / 660ltr total capacity
  - 2 x Fresh water pressure pump with accumulator tank
  - 2 x Hot water cylinders with increased capacity**
- Transom shower (Hot and cold)
- Automatic shower drain pumps
- 2 x Holding tanks
- 2 x Electric bilge pumps (keel sump) with float switches and visual notification at helm station
- 2 x High water bilge float switches(keel sump) with audible alarm
- 2 x Manual bilge pumps (keel sump)
- 2 x Electric bilge pumps (engine room) with float switch and warning light at switch panel
- 1 x Portable manual bilge pump
- Freshwater connection
- Water purifying filter system (Purifying water tap located at galley)

### GENERAL EQUIPMENT

- **Mooring / dock lines / fenders**
- **Safety pack**
- **Charter pack**
- **Commissioning and delivery to charter base**

### CERTIFICATIONS

- CE Certification
- NMMA Certification

### NOTE

The Builder reserves the right to change or amend the contents of this document at any time without prior notification to any third party, and no liability will be accepted for errors contained within the same.